

Kit 1040

FORD Galaxy, 5-dr MPV, 96-00

SEAT Alhambra, 5-dr MPV, 96-00

VOLKSWAGEN Sharan, 5-dr MPV, 96-00

480R
754

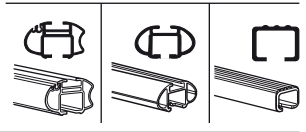
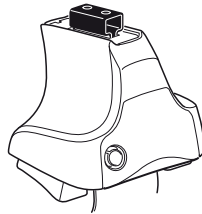

480

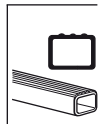
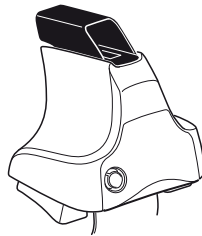

750

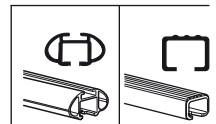
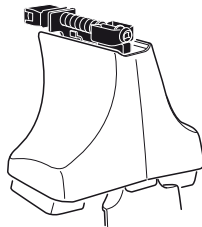

Max. 75kg
Max. 165 lbs

x1
 x4
 x4
 x4
 x4

480R/754

x1
 x4
 x4
 x4

480

x1
 x4
 x4

750

x2 x2 x2 x4	x2	x2 x2 x4 x4	x2 x2	x2

x1

Kit



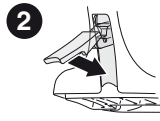
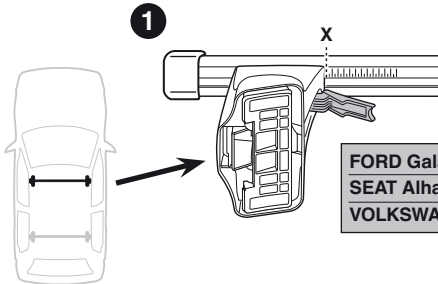

	X
FORD Galaxy, 5-dr MPV, 96-00	39
SEAT Alhambra, 5-dr MPV, 96-00	39
VOLKSWAGEN Sharan, 5-dr MPV, 96-00	39

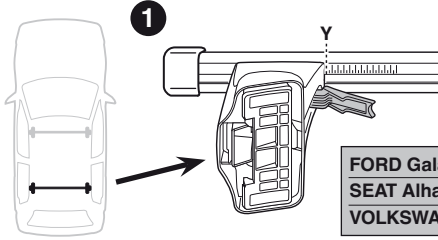

	Y
FORD Galaxy, 5-dr MPV, 96-00	35,5
SEAT Alhambra, 5-dr MPV, 96-00	35,5
VOLKSWAGEN Sharan, 5-dr MPV, 96-00	35,5

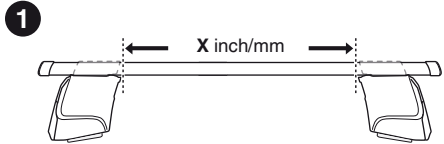
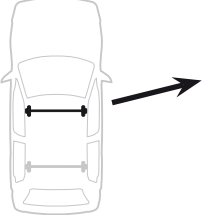
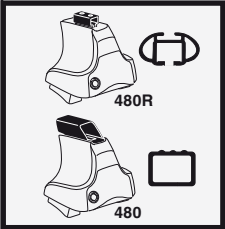

	X inch	X mm
FORD Galaxy, 5-dr MPV, 96-00	41"	1041 mm
SEAT Alhambra, 5-dr MPV, 96-00	41"	1041 mm
VOLKSWAGEN Sharan, 5-dr MPV, 96-00	41"	1041 mm

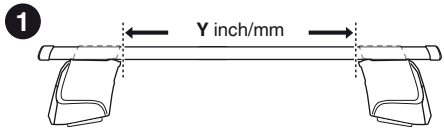
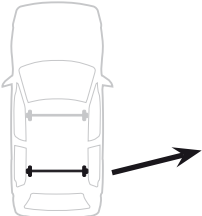

	Y inch	Y mm
FORD Galaxy, 5-dr MPV, 96-00	39 5/8"	1006 mm
SEAT Alhambra, 5-dr MPV, 96-00	39 5/8"	1006 mm
VOLKSWAGEN Sharan, 5-dr MPV, 96-00	39 5/8"	1006 mm

4

FORD Galaxy, 5-dr MPV, 96-00

SEAT Alhambra, 5-dr MPV, 96-00

VOLKSWAGEN Sharan, 5-dr MPV, 96-00

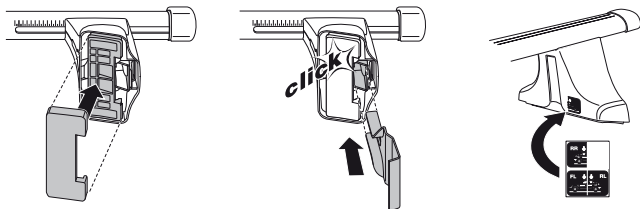
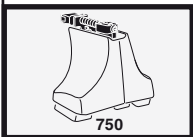
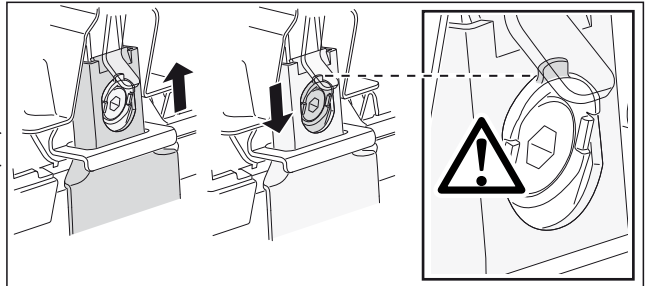
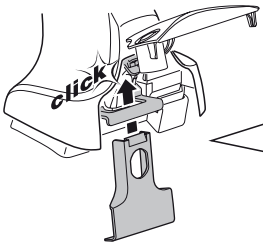
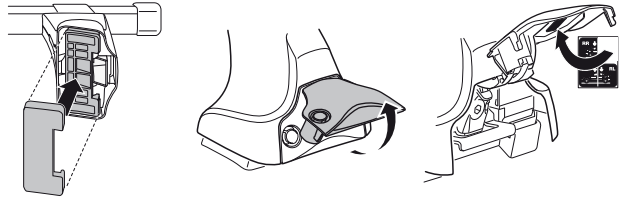
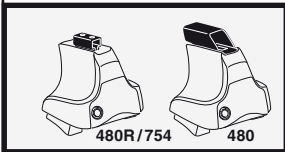
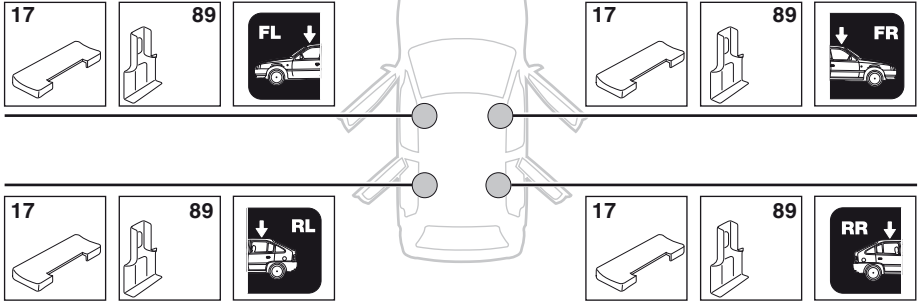

5



	X mm	Y mm	X inch	Y inch
FORD Galaxy , 5-dr MPV, 96-00	400 mm	700 mm	15 ³ / ₄ "	27 ¹ / ₂ "
SEAT Alhambra , 5-dr MPV, 96-00	400 mm	700 mm	15 ³ / ₄ "	27 ¹ / ₂ "
VOLKSWAGEN Sharan , 5-dr MPV, 96-00	400 mm	700 mm	15 ³ / ₄ "	27 ¹ / ₂ "

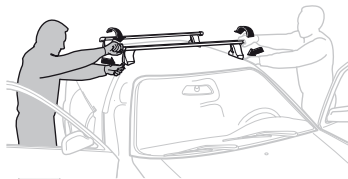
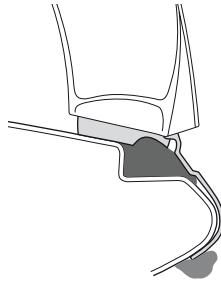
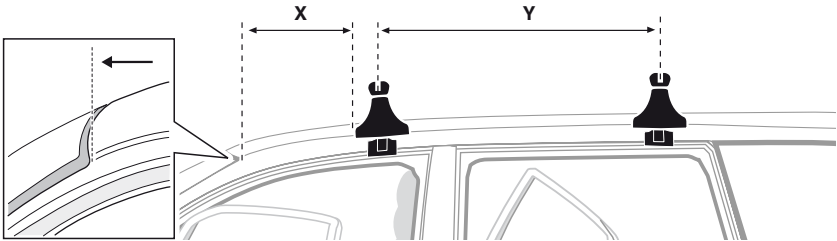

GB/US Tighten alternately

D Die Schrauben abwechselnd anziehen

F Serrer alternativement chaque côté

NL Afwisselend aan de linker- en de rechterkant aandraaien

I Alternare il serraggio delle viti

E Apretar alternativamente

PT Aperte alternadamente

S Dra åt växelvis

FIN Kierrä vuorotellen

EST Pinguldage vaheldumisi

LAT Pielvelciet pamišus

LIT Užsukinėkite pakaitomis

PL Śruby dokręcaj naprzemiennie

RU Затягивайте попеременно

CZ Pokręťta bagażníka dokręcaj dokręcaj naprzemiennie.

SK Doťahujte striedavo

SLO Privijajte izmenično.

HR Naizmjenično zategnite

HU Egymástól függetlenül szorítandó

GR Σφίγγετε εναλλάξ

TR Dönüşümlü sıkın

中文 交替拧紧

한국어 번갈아 가며 조이십시오.

日本語 交互に締め付けてください。

ไทย ชั้้นโน้แบบสลับ

6



480R/754



480



*
3 Nm



*

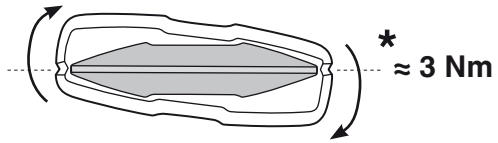

*
≈ 3 Nm

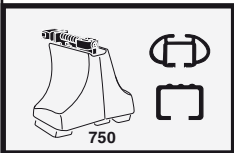
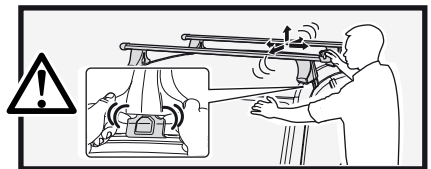

750

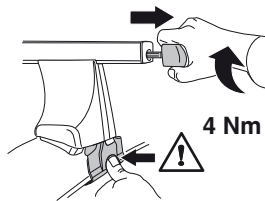

4 Nm

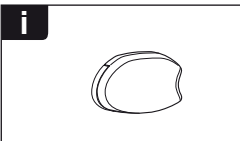
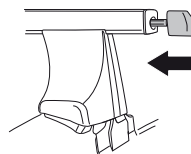

i

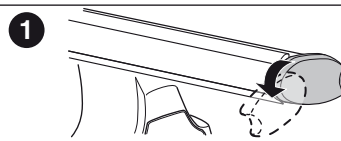

1

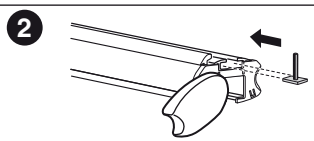

2

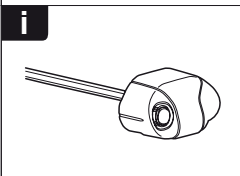

i

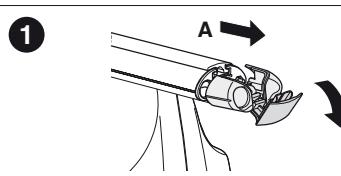

1

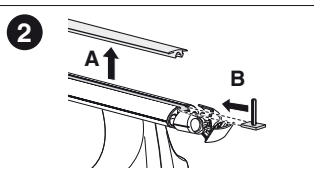

2

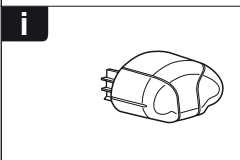

i

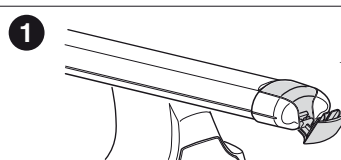

1

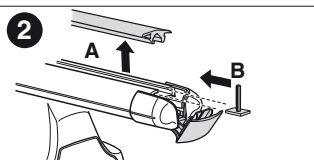

2

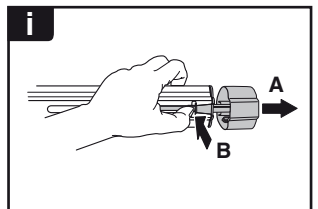
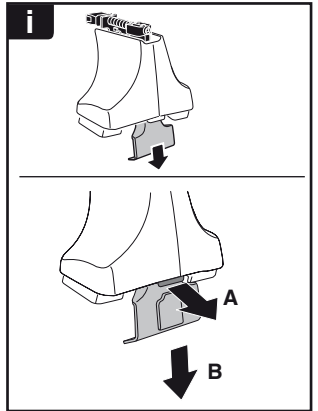

THULE
SWEDEN
**ONE
KEY
SYSTEM**



		(x4)
		(x6)
		(x8)
NA		(x10)
EUR		(x12)
ASIA		(x12)



WW ▶ Thule Sweden AB, Box 69, 330 33 Hillerstorp, SWEDEN
NA ▶ Thule Inc., 42 Silvermine Road, Seymour, Connecticut 06483, USA

info@thule.com
customer.service@thule.com

www.thule.com